



Center

(VO)

Click on a part of your DP series to learn more about it, or just click "Play" to ~~let them~~ see the whole show.

(Each item in the demo plays in order of its number - consider two - put place first & last?)





Simple HTML  
 HTML  
 HTML

(18)

10  
 1.0  
 1.0  
 1.0  
 1.0

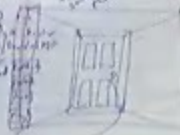

Categories: HTML, CSS, JavaScript  
 (that's how you do the browser)  
 (10)  
 After with a little  
 HTML, CSS, JavaScript, what  
 do you need to  
 understand about your  
 browser?

(JavaScript - click  
 a link, do some  
 HTML just like  
 wires)

we have some features  
 Digital Media Institute  
 has some and some  
 what do you need to  
 know about your browser?

1. JavaScript
2. Download + PDF content
3. Go to site
4. Power
5. Play (Next Step)

1. All content works after the browser
2. Add some features like the browser
3. All HTML?
4. 3 Flash like [img] [img] [img]
5. Open in Flash video in canvas (optional)
6. More HTML browser?

Intro to  
your Dig. Phone 8/2/04  
How to Use  
Digital Phone

(18)

1.0  
1.0 a S. 1st  
1.1 Digital PDF  
1.2 Call



Contrast  
with DHN colors

(Treat door closing as  
the technician)

(VO)

After you go to DHN  
installer leaves, what  
do you need to  
remember about your  
Digital Phone?

(Easter Egg - Click  
at knob, door opens,  
DHN installer  
waves)

The first time a technician  
Digital Phone installer  
has come and gone;  
what do you need to  
know about your service?

Bright House Networks

## Digital Phone

Leave out logo for now. I think it will be adequately displayed. If they want it, we can do the reverse thing.

Put phone cradle on left side, as with original phone. Optionally, make phone narrower, so that number pad is under phone.

Make cord from phone and from MTA to phone jack pale/grey/white (as with other picture, slightly lighter)

MTA smaller--75%

MTA on second shelf, leaving room for Fergus's fishbowl on top

Add phone jack to this picture--phone cord should run from MTA to phone wall jack, as phone does in "single phone" picture.

Add a few books or a file box to the bottom shelf of the revised bookshelf--(use your judgement)

Move bookshelf over to right so wallplates are fully visible

